

TS 560D

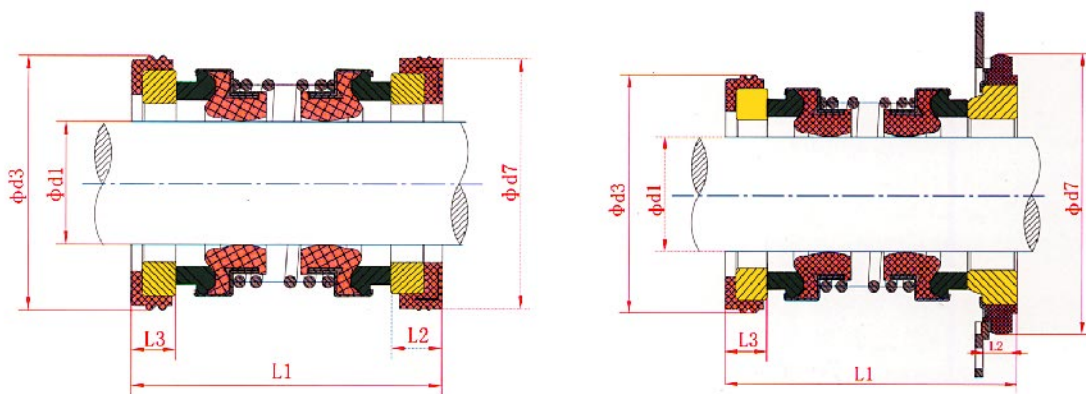

技术参数:
 压力: $\leq 0.3\text{MPa}$
 线速度: $\leq 10\text{米/秒}$
 温度: $-30^{\circ}\text{C} \sim +200^{\circ}\text{C}$

Operating Limits:
 Pressure: $\leq 0.3\text{MPa}$
 Speed: $\leq 10\text{m/s}$
 Temperature: $-30^{\circ}\text{C} \sim +200^{\circ}\text{C}$

- 静环 (陶瓷/碳化硅/碳化钨) Stationary Ring (Ceramic/SiC/TC)
- 动环 (热压石墨/车制石墨/碳化硅/碳化钨) Rotary Ring (Plastic Carbon/Carbon/ SiC/TC)
- 辅助密封 (丁腈胶/三元乙丙胶/氟胶) Secondary Ring (NBR/EPDM/VITON)
- 弹簧及冲件 (不锈钢) Spring and Other Parts (SUS304/SU S316)

Model	d1	d3	d7	L1	L2	L3
TS560D-13	13	25	25	36	5	5
TS560D-14	14	30	30	37	5	5
TS560D-15	15	30	30	37	5	5
TS560D-16	16	30	30	37	5	5
TS560D-18	18	35	38	49	7	10
TS560D-19	19	35	38	49	7	10
TS560D-20	20	38	44	49	7	7
TS560D-25	25	44	50	51	7	7
TS560D-30	30	50	57	59	9	8
TS560D-35	35	58	64	61	9	9
TS560D-40	40	64	70	64	11	9
TS560D-45	45	66	70	65	10	9
TS560D-50	50	72	80	69	10	9